

NOTES:  
 1. DUE TO OUR CONTINUOUS IMPROVEMENT PROGRAM, ALL MODELS AND SPECIFICATIONS ARE SUBJECT TO CHANGE WITHOUT NOTICE.

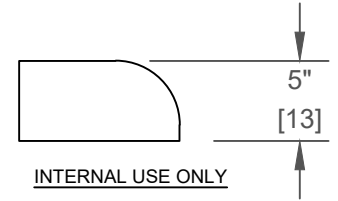
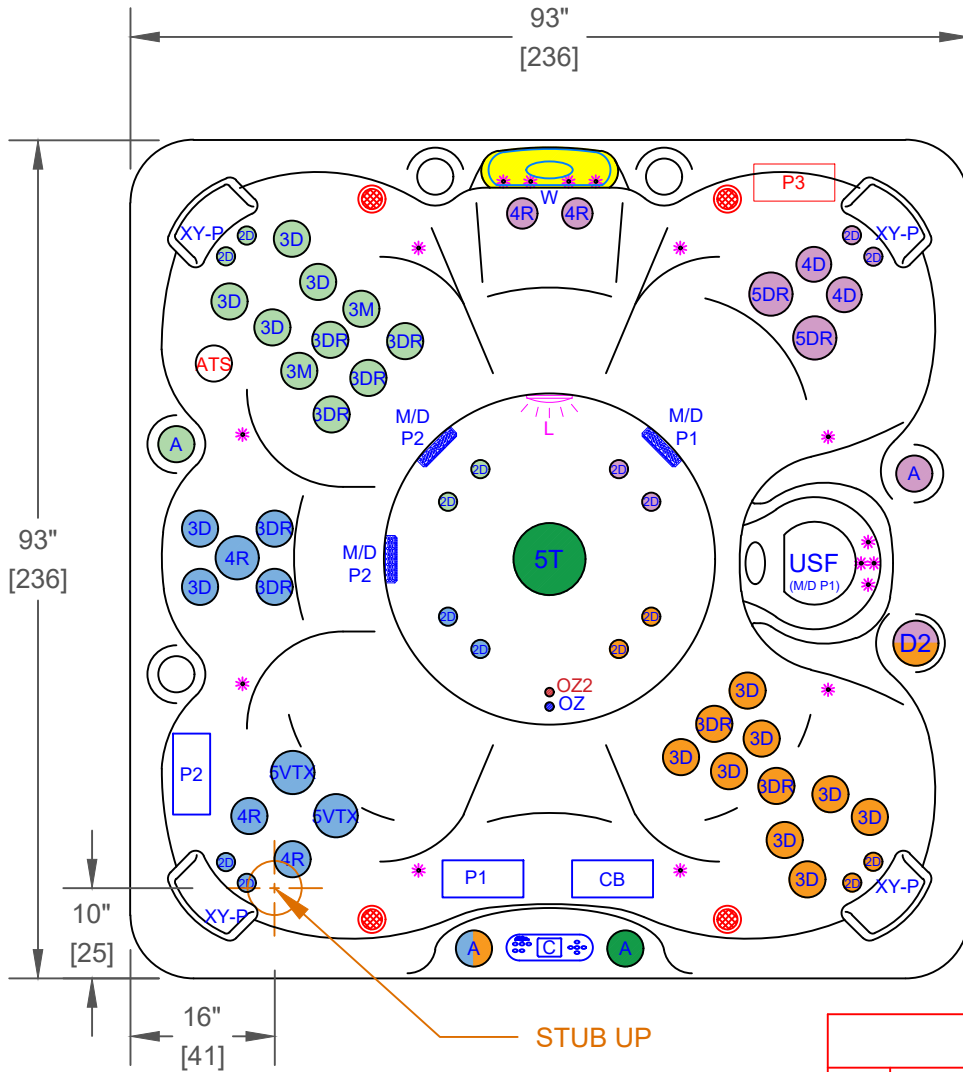

	PUMP 1
	PUMP 2
	PUMP 1
	PUMP 2
	CONTROL BOX

### EC-851B - LEGEND

SYMB.	DESCRIPTION	PART NUMBER	QTY.
2D	2" CLUSTER STORM DIRECTIONAL VECTOR X	PLUCS2440019S-HLG	16
3D	3" MINI STORM DIRECTIONAL VECTOR X	PLUCS2445009SS-HLG	14
3M	3" MINI STORM MASSAGE DIRECTIONAL VECTOR X	PLUCS2445059S-HLG	2
3DR	3" MINI STORM TWISTER VECTOR X	PLUCS2441049S-HLG	8
4D	4.5" POLY STORM DIRECTIONAL VECTOR X	PLUCS2446009SS-HLG	2
4R	4.5" POLY STORM ROTO VECTOR X	PLUCS2446039S-HLG	5
5VTX	5" POWER STORM TRI DIRECTIONAL VECTOR X	PLUCS2447019S-HLG	2
5DR	5" POWER STORM TWISTER VECTOR X	PLUCS2447049SS-HLG	2
5T	5" ADJUSTABLE WHIRLPOOL VECTOR X WITH VALVE	PLUCS2394029S-HLG	1
D2	ORION 2" WATER DIVERTER VALVE	PLUCS600-7609-CDHL	1
A	ORION AIR CONTROL VALVE	PLUCS660-7609-CDHL	4
W	LED WATERFALL		1
USF	75 SQ. FT. ULTRA SKIM FILTER	517-4619LC-HLG	1
M/D	MAIN DRAIN	PLU644-5416-HLG V	3
XY-P	TEXTURED Y-PILLOW (WHITE)		4
C	TP700		1
OZ	PURE SILK OZONATOR WITH MAZZIE INJECTOR AND MIXING CHAMBER		1
L	5" MULTI COLORED LED LIGHT		1
*	PERIMETER LED LIGHTING		1
-	FILTER LID (SINGLE FLT)	FIL11300260	1

### OPTIONS

SYMB.	DESCRIPTION	OPTION NUMBER
ATS	EXCLUSIVE ADJUSTABLE THERAPY SYSTEM PLUS (ATS PLUS)	OPT25-109
P3	ADDITIONAL 3RD PUMP 1 X 6 BHP (OPTION WILL UPGRADE CONTROL BOX TO BP501X)	OPT25-138B-3P N/A WITH ATS OR 24/7
OZ2	TWIN PURE SILK SYSTEM DIAL OZONATORS WITH MAZZIE INJECTORS AND MIXING CHAMBERS	OPT25-102DX-1
	CAL SPAS SALT SYSTEM	OPT25-113S
-	PURE CURE UV PURIFICATION SYSTEM	OPT25-191B
	24/7 FILTRATION SYSTEM	OPT25-112C
-	ABS MOLDED BOTTOM TRAY	OPT25-990-7
-	CAL CONNECT RF MODULE	OPT25-168RF
-	ELITE HORIZONTAL CABINET PANELS AND BLACK BEAM CORNERS (COLORS: GREY, MOCHA, LIME OAK)	OPT25-E981
	FREEDOM SOUND SYSTEM BLUETOOTH, POWERED SUBWOOFER AND 4X SPEAKERS	OPT25-FS43
-	THERMO-GUARD FULL FOAM	OPT25-900
-	*THIS OPTION WILL REPLACE THERMO-SHIELD	

PROPRIETARY AND CONFIDENTIAL THE INFORMATION CONTAINED IN THIS DRAWING IS THE SOLE PROPERTY OF CAL SPAS. ANY REPRODUCTION IN PART OR AS A WHOLE WITHOUT THE WRITTEN PERMISSION OF CAL SPAS IS PROHIBITED.		 CAL SPAS INC. 1442 EAST NINTH STREET, POMONA, CA 91766	
SPECIFICATIONS		TITLE	JET LAYOUT - STD
DIMENSION (in)	93"x93"x40-1/2"	LINE	ESCAPE
DIMENSION (cm)	236x236x100	MODEL	2025 SPA LINE BEL AIR
DRY WEIGHT	900 LBS [408 Kg]	NUM	EC-851B
FILLED WEIGHT	4650 LBS [2109 Kg]	DWG NO.	CS003361
WATER CAP.	450 GAL [1703 L]	SCALE	NTS
		REV	A
		SHEET 1 OF 1	